

Head Office:
Dixon Kelley Estate Agents
1 Penn Court
Station Road, West Moors
Dorset. BH22 0JJ

Telephone: 01202 877511

DORSET PARK HOMES

DRAFT

www.dorsetparkhomes.com

23 Selwood Park, Weymans Avenue, Kinson, Bournemouth. BH10 7JU



Well Presented Park Home

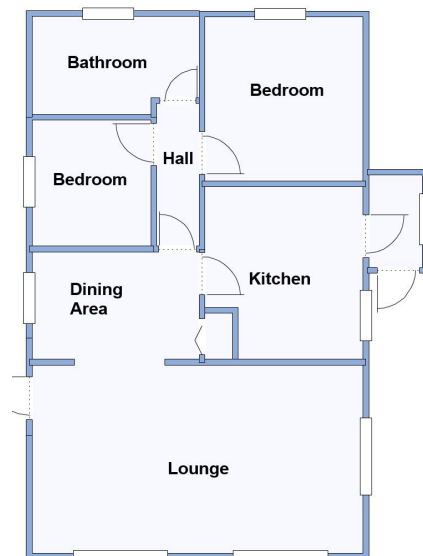

This drawing has been prepared for diagrammatic purpose only. Not to scale

2 Bedroom Park Home approx 32' x 20'

Accommodation & approximate room dimensions:

- Wonderland 'Shaftesbury' Park Home circa 1988
- Entrance Porch
- Lounge: approx 19'6" x 11'. Feature fireplace. 2 bay windows. Door to garden.
- Dining Area: approx 10' x 6'4" Cupboard housing combination gas boiler.
- Kitchen: approx 10'2" x 9'4". Range of base & wall units. Space for cooker, washing machine & tall fridge/freezer. Door to side porch.
- Bedroom 1: approx 9'8" x 9'6". Fitted wardrobes.
- Bedroom 2: approx 7'6" x 7'2". Fitted wardrobes.
- Bathroom: Panelled bath with Mira shower over. Pedestal wash basin & WC.
- Gas Central Heating (system untested)
- PVCu Double-Glazing & Exterior Insulation System
- Parking on Plot
- Delightful Patio Garden, field view. Garden Shed
- Age restriction 50+. 1 Pet Considered
- Popular, well maintained Residential Park close to local amenities & with easy access to Bournemouth & Poole.

Backing onto Fields



Kitchen



Lounge



Delightful Garden



Dining Area

Price £140,000

VIEWING STRICTLY BY APPOINTMENT WITH THE VENDOR'S AGENT Dorset Park Homes 01202 877511

IMPORTANT NOTE: These particulars are believed to be correct but their accuracy is not guaranteed. They do not form part of any contract. Nothing in these particulars shall be deemed to be a statement that the property is in good structural condition or otherwise, nor that any of the services, appliances, equipment or facilities are in good working order or have been tested. Purchasers should satisfy themselves on such matters prior to purchase Ref.W05084

Pitch Fee: Approx £195.43 per month
Subject to Annual Review
Council Tax Band: 'A'

Tenure: 1983 Mobile Homes Act Agreement

The recommended specialist in Park Home sales
Proprietor: Simon Dixon

