

**Head Office:**  
Dixon Kelley Estate Agents  
1 Penn Court  
Station Road, West Moors  
Dorset. BH22 0JJ

# DORSET PARK HOMES

**DRAFT**

[www.dorsetparkhomes.com](http://www.dorsetparkhomes.com)

**Telephone: 01202 877511**

**59 Gladelands Park, Ringwood Road, Ferndown. BH22 9BW**



**Well presented Park Home close to amenities**

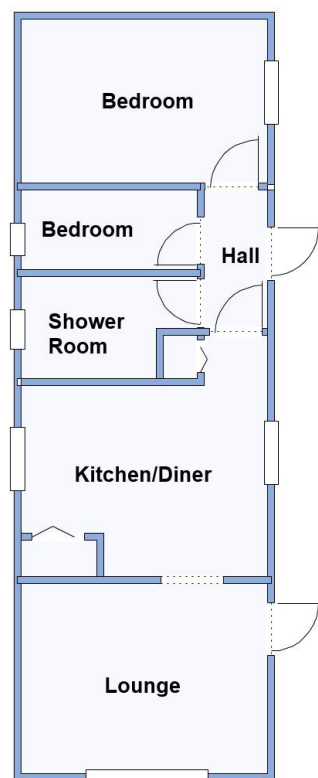

This drawing has been prepared for diagrammatic purpose only. Not to scale.

## 2-Bedroom Park Home - approx 36' x 12'

Accommodation & approximate room dimensions:

- Entrance Hall
- Kitchen/Diner: approx 11'4" x 11'6" max. Range of floor and wall cupboards. Cooker point. Plumbing for washing machine. Space for fridge/freezer. Airing cupboard.
- Lounge: approx 11'6" x 9'. Feature fireplace with gas fire & back boiler. Door to garden.
- Bedroom 1: approx 11'6" x 7'9" max. Fitted wardrobes & dresser unit.
- Bedroom 2: approx 8'5" x 3'9". Fitted wardrobe.
- Shower Room: Walk-in shower with thermostatic shower fitted. Vanity wash basin & WC. Chrome heated towel rail.
- Gas Central Heating (system untested)
- PVCu Double-Glazing
- Garden mainly laid to lawn & Concrete Shed
- Parking for 1 car (potential for 'on-plot' parking subject to site owners consent which may or may not be given).
- Age Restriction 50+
- No Pets Allowed
- Popular well maintained Residential Park near to shops & services.

**No Chain!**



**Price: £99,950**

**Pitch Fee: approx £193.18 pcm Water/Sewerage £20.00 approx per month  
Subject to Annual Review  
Council Tax Band: 'A' Tenure: 1983 Mobile Homes Act Agreement**

**VIEWING STRICTLY BY APPOINTMENT WITH THE VENDOR'S AGENT Dorset Park Homes 01202 877511**

**IMPORTANT NOTE:** These particulars are believed to be correct but their accuracy is not guaranteed. They do not form part of any contract. Nothing in these particulars shall be deemed to be a statement that the property is in good structural condition or otherwise, nor that any of the services, appliances, equipment or facilities are in good working order or have been tested. Purchasers should satisfy themselves on such matters prior to purchase Ref.W05122

*The recommended specialist in Park Home sales*  
Partner: Simon Dixon

