

Head Office:
Dixon Kelley Estate Agents
1 Penn Court
Station Road, West Moors
Dorset. BH22 0JJ

Telephone: 01202 877511

DORSET PARK HOMES

DRAFT

www.dorsetparkhomes.com

160 West Drive, Oaktree Park, St Leonards, Ringwood. BH24 2RT

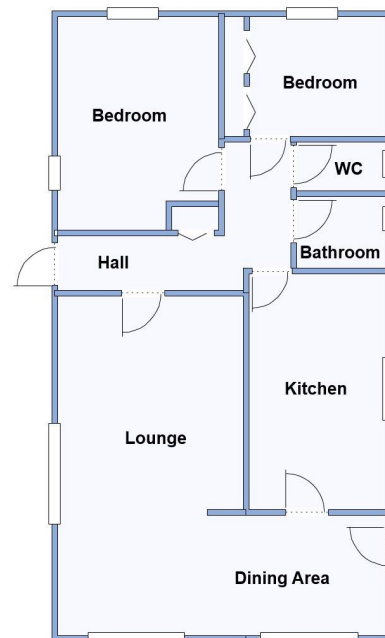

This drawing has been prepared for diagrammatic purpose only. Not to scale

2 Bedroom Park Home approx 36' x 20'

Accommodation & approximate room dimensions:

- Omar 'Ashdale'
- Entrance Hall: Cloaks cupboard
- Lounge: approx 19'10" x 10'9".
- Dining Area: approx 9'3" x 7'
- Kitchen: approx 13'6" x 8'4". Range of floor and wall cupboards. Built in high level oven & hob with cooker hood over. Space for washing machine, fridge & freezer. Wall mounted combination gas boiler.
- Bedroom 1: approx 12'5" x 9'5". Farmland views
- Bedroom 2: approx 9'5" x 7'. Built-in wardrobes. Farmland views.
- Bathroom: Panelled bath with shower over & screen fitted. Vanity unit.
- Separate WC
- Gas Central Heating (new installed boiler 2024)
- PVCu Double-Glazing
- Parking for 1 car
- Age restriction 50+ Pets Considered
- Delightful Garden overlooking small stream & farmland. Metal Shed
- Well Maintained Residential Park with active Members Club & adjacent to forestry walks.

Popular 'Pet Friendly' Park

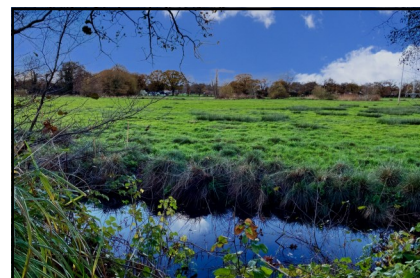

Pitch Fee: approx £223.07 per month
Subject to Annual Review
Council Tax Band: 'A'

Tenure: 1983 Mobile Homes Act Agree-

Price £120,000

VIEWING STRICTLY BY APPOINTMENT WITH THE VENDOR'S AGENT Dorset Park Homes 01202 877511

IMPORTANT NOTE: These particulars are believed to be correct but their accuracy is not guaranteed. They do not form part of any contract. Nothing in these particulars shall be deemed to be a statement that the property is in good structural condition or otherwise, nor that any of the services, appliances, equipment or facilities are in good working order or have been tested. Purchasers should satisfy themselves on such matters prior to purchase Ref.W04628

The recommended specialist in Park Home sales
Proprietor: Simon Dixon

