

**Head Office:**  
Dixon Kelley Estate Agents  
1 Penn Court  
Station Road, West Moors  
Dorset. BH22 0JJ

# DORSET PARK HOMES

**DRAFT**

[www.dorsetparkhomes.com](http://www.dorsetparkhomes.com)

**Telephone: 01202 877511**

**110 The Square, Oaktree Park, St Leonards, Ringwood. BH24 2RL**



**Immaculate Home on Popular 'Pet Friendly' Park**

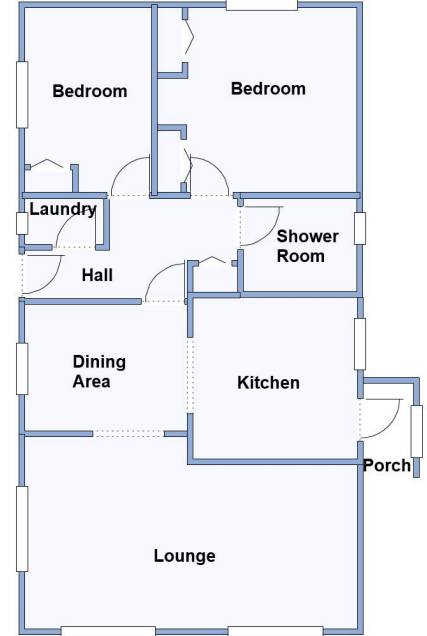

This drawing has been prepared for diagrammatic purpose only. Not to scale.

## 2-Bedroom Park Home - approx 36' x 20'

**Accommodation & approximate room dimensions:**

- **Entrance Hall:** Cloaks/Boiler cupboard boiler.
- **Dining Area:** approx 9'8" x 7'4". Opening to:
- **Kitchen:** approx 9'7" x 9'4". Newly fitted high quality kitchen with a good range of base & wall units. Built-in oven, hob & hood. Space for fridge/freezer. Door to side porch.
- **Lounge:** approx 19'5" x 11' max. 2 bay windows.
- **Laundry:** Worktop & space for washing machine.
- **Bedroom 1:** approx 11'7" x 10'9". Fitted wardrobes
- **Bedroom 2:** approx 10'9" x 7'4". Fitted wardrobe
- **Shower Room:** Newly installed shower room with corner shower, vanity wash basin & WC. Chrome heated towel rail.
- **Gas Central Heating (New system 2025)**
- **New Carpets & Flooring Throughout**
- **Approval for Parking on Plot**
- **Delightful Patio Garden with Deck. Metal Shed.**
- **Age Restriction 50+ Pets Considered**
- **Residents Members Club on Park**
- **Popular Park between Ringwood & Ferndown and adjacent to protected forestry land. Useful convenience store in neighbouring holiday park.**

## Delightful Garden



Superb Kitchen



Large Lounge



Dining Area



Delightful Garden

**Pitch Fee: approx £223.07 per month**  
**Subject to Annual Review**  
**Council Tax Band: 'A'**

**Tenure: 1983 Mobile Homes Act Agreement**

**Price: £165,000**

**VIEWING STRICTLY BY APPOINTMENT WITH THE VENDOR'S AGENT Dorset Park Homes 01202 877511**

**IMPORTANT NOTE:** These particulars are believed to be correct but their accuracy is not guaranteed. They do not form part of any contract. Nothing in these particulars shall be deemed to be a statement that the property is in good structural condition or otherwise, nor that any of the services, appliances, equipment or facilities are in good working order or have been tested. Purchasers should satisfy themselves on such matters prior to purchase. Ref.W05149

*The recommended specialist in Park Home sales*  
Partner: Simon Dixon

