

**Head Office:**  
Dixon Kelley Estate Agents  
1 Penn Court  
Station Road, West Moors  
Dorset. BH22 0JJ

**Telephone: 01202 877511**

# DORSET PARK HOMES

**DRAFT**

[www.dorsetparkhomes.com](http://www.dorsetparkhomes.com)

**4 Ashley Wood Park, Tarrant Keyneston, Blandford, Dorset. DT11 9JJ**



**Park Home on Delightful Small Park**

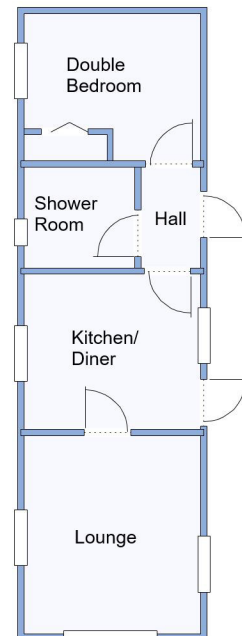

This drawing has been prepared for diagrammatic

## 1-Bedroom Park Home - approx 36' x 10'

**Accommodation & approximate room dimensions:**

- Single Unit Park Home
- Entrance Hall
- Kitchen/Diner: approx 9'6" x 8'4". Range of floor & wall cupboards. Built-in electric oven and gas hob with extractor fan above (untested). New Gas boiler. Plumbing for washing machine. Space for fridge/freezer. Laminate floor.
- Lounge: approx 10'8" x 9'6". Double aspect windows. Laminate floor.
- Double Bedroom: approx 9'6" x 7'11". Built-in wardrobe with sliding doors.
- Shower Room: Corner glass shower cubicle. Vanity wash basin with cupboard below. WC & Chrome heated towel rail.
- LPG Gas Central Heating (New Boiler Feb 2025)
- PVCu Double-Glazing
- Patio Garden with shrub borders. New Metal Shed.
- Parking on Plot
- Age Restriction 50+
- 2 Dogs considered, no cats
- Pleasant Residential Park between Wimborne & Blandford.

## Semi-Rural Location

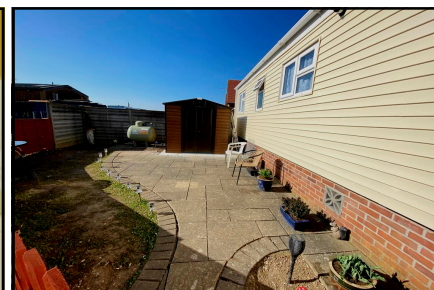

**Pitch Fee: approx £183.89 per month**

**Subject to Annual Review**

**Council Tax Band: 'A'**

**Tenure: 1983 Mobile Homes Act Agreement**

**Price: £67,000**

**VIEWING STRICTLY BY APPOINTMENT WITH THE VENDOR'S AGENT Dorset Park Homes 01202 877511**

**IMPORTANT NOTE:** These particulars are believed to be correct but their accuracy is not guaranteed. They do not form part of any contract. Nothing in these particulars shall be deemed to be a statement that the property is in good structural condition or otherwise, nor that any of the services, appliances, equipment or facilities are in good working order or have been tested. Purchasers should satisfy themselves on such matters prior to purchase Ref.W0500

*The recommended specialist in Park Home sales*  
Proprietor: Simon Dixon

